

ICBCW24/B

### FEATURES

Gentle heat warms cups, dishes

---

50 lb. capacity - room for 40 cups!

---

Hidden interior control panel

---

Removable non-slip mat

---

Push to open

---

Black glass and stainless steel options

---

Rigorously tested in our U.S. manufacturing facilities for decades of use



**PRODUCT SPECIFICATIONS**

Model	ICBCW24/B
Dimensions	597 mm W x 140 mm H x 533 mm D
Weight	60 lb
Electrical Supply	220-240 VAC, 50/60 Hz
Electrical Service	10 amp dedicated circuit
Overall Capacity	0.8 cu ft
Power Cord Length	3 feet

**ELECTRICAL**

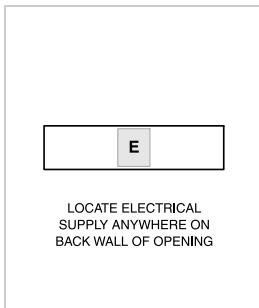

**DIMENSIONS**

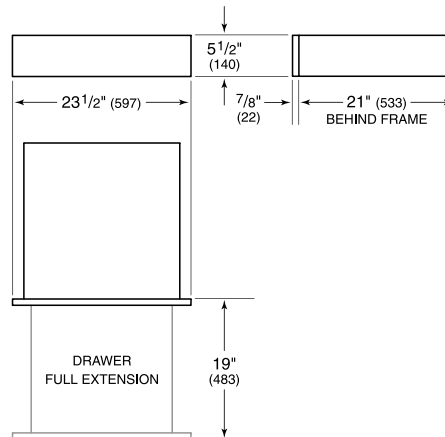

**STANDARD INSTALLATION**

