

ICBCW24/B

FEATURES

Gentle heat warms cups, dishes

50 lb. capacity - room for 40 cups!

Hidden interior control panel

Removable non-slip mat

Push to open

Black glass and stainless steel options

Rigorously tested in our U.S. manufacturing facilities for decades of use



PRODUCT SPECIFICATIONS

| | |
|--------------------|--------------------------------|
| Model | ICBCW24/B |
| Dimensions | 597 mm W x 140 mm H x 533 mm D |
| Weight | 60 lb |
| Electrical Supply | 220-240 VAC, 50/60 Hz |
| Electrical Service | 10 amp dedicated circuit |
| Overall Capacity | 0.8 cu ft |
| Power Cord Length | 3 feet |

ELECTRICAL

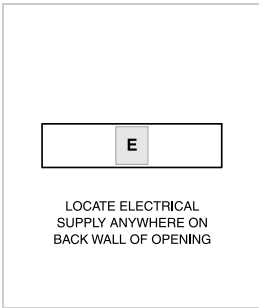

DIMENSIONS

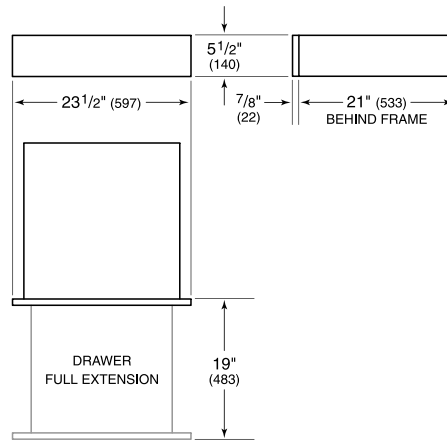

FLUSH INSTALLATION

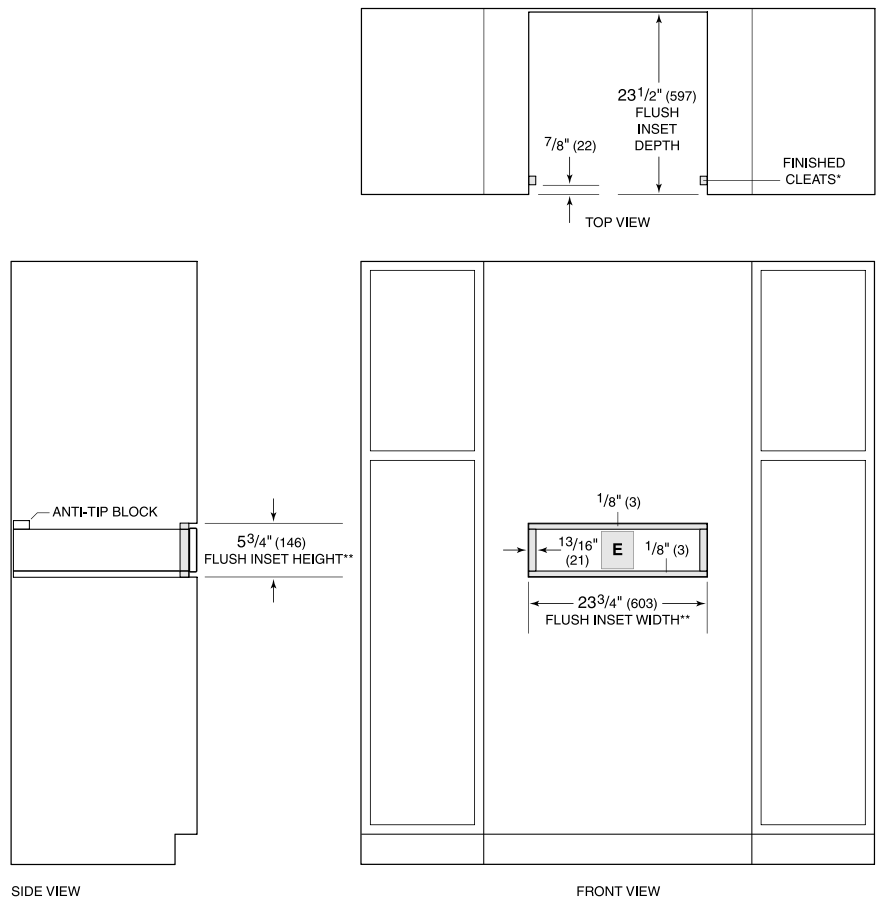

*Will be visible and should be finished to match cabinetry.
 **Dimension provides minimum reveals.